

**MPT NOTES:**

- THIS WORK CONSISTS OF THE MAINTENANCE AND PROTECTION OF TRAFFIC AND THE PROTECTION OF THE PUBLIC WHEN APPROACHING AND DEPARTING THE CONSTRUCTION AREA AND WITHIN THE LIMITS OF CONSTRUCTION.
- FURNISH, ERECT, PLACE AND MAINTAIN TRAFFIC CONTROL SIGNS AND DEVICES. MAINTAIN TRAFFIC DURING HOURS OF CONSTRUCTION AND AT ALL OTHER TIMES CONSISTENT WITH THE METHODS INDICATED ON THESE DRAWINGS AND THE FOLLOWING:
  - PENNDOT PUBLICATION 35;
  - PENNDOT PUBLICATION 46;
  - PENNDOT PUBLICATION 72M;
  - PENNDOT PUBLICATION 111;
  - PENNDOT PUBLICATION 212;
  - PENNDOT PUBLICATION 213;
  - PENNDOT PUBLICATION 236;
  - PENNDOT PUBLICATION 408; AND
  - MUTCD, CURRENT EDITION.
- REMOVE THESE DEVICES IMMEDIATELY UPON COMPLETION OF THE WORK. PENNDOT WILL REMOVE ANY TRAFFIC CONTROL DEVICES ERECTED BY DEPARTMENT FORCES.
- PERMITTEE MUST ARRANGE FOR INSPECTION OF ALL TRAFFIC CONTROL DEVICES PRIOR TO START OF WORK.
- COVER OR REMOVE ALL CONFLICTING SIGNS AND ERADICATE ALL CONFLICTING PAVEMENT MARKINGS.
- MOUNT ALL LONG-TERM ADVANCE WARNING SIGNS ON TYPE III BARRICADES UNLESS OTHERWISE NOTED OR INSTRUCTED BY DISTRICT OFFICE.
- ALL SIGNS AND DEVICES TO BE MAINTAINED IN NEW OR LIKE NEW CONDITION.
- DRIVEWAYS WILL BE KEPT ACCESSIBLE AT ALL TIMES. LOCATE ALL SIGNS SO THAT SIGHT DISTANCES WILL NOT BE OBSTRUCTED AT DRIVEWAYS AND LOCAL ROADS.
- PERMITTEE SHALL NOTIFY LOCAL EMERGENCY AUTHORITIES (E.G., POLICE, FIRE, MEDICAL), AFFECTED BUSINESSES, SCHOOL DISTRICT(S), THE GENERAL PUBLIC, THE DISTRICT PERMIT MANAGER AND THE DISTRICT APRAS COORDINATOR AT LEAST FOURTEEN DAYS PRIOR TO ANY SIGNIFICANT TRAFFIC IMPACTS (E.G., LATERAL WIDTH RESTRICTIONS LESS THAN 16 FEET, DETOURS).
- MAINTENANCE AND PROTECTION OF TRAFFIC DURING CONSTRUCTION SHALL BE IN ACCORDANCE WITH APPLICABLE PATA DRAWING(S) IN THE CURRENT PENNDOT PUBLICATION 213, "TEMPORARY TRAFFIC CONTROL GUIDELINES."
- DETOUR DURATION SHALL NOT EXCEED 365 DAYS.

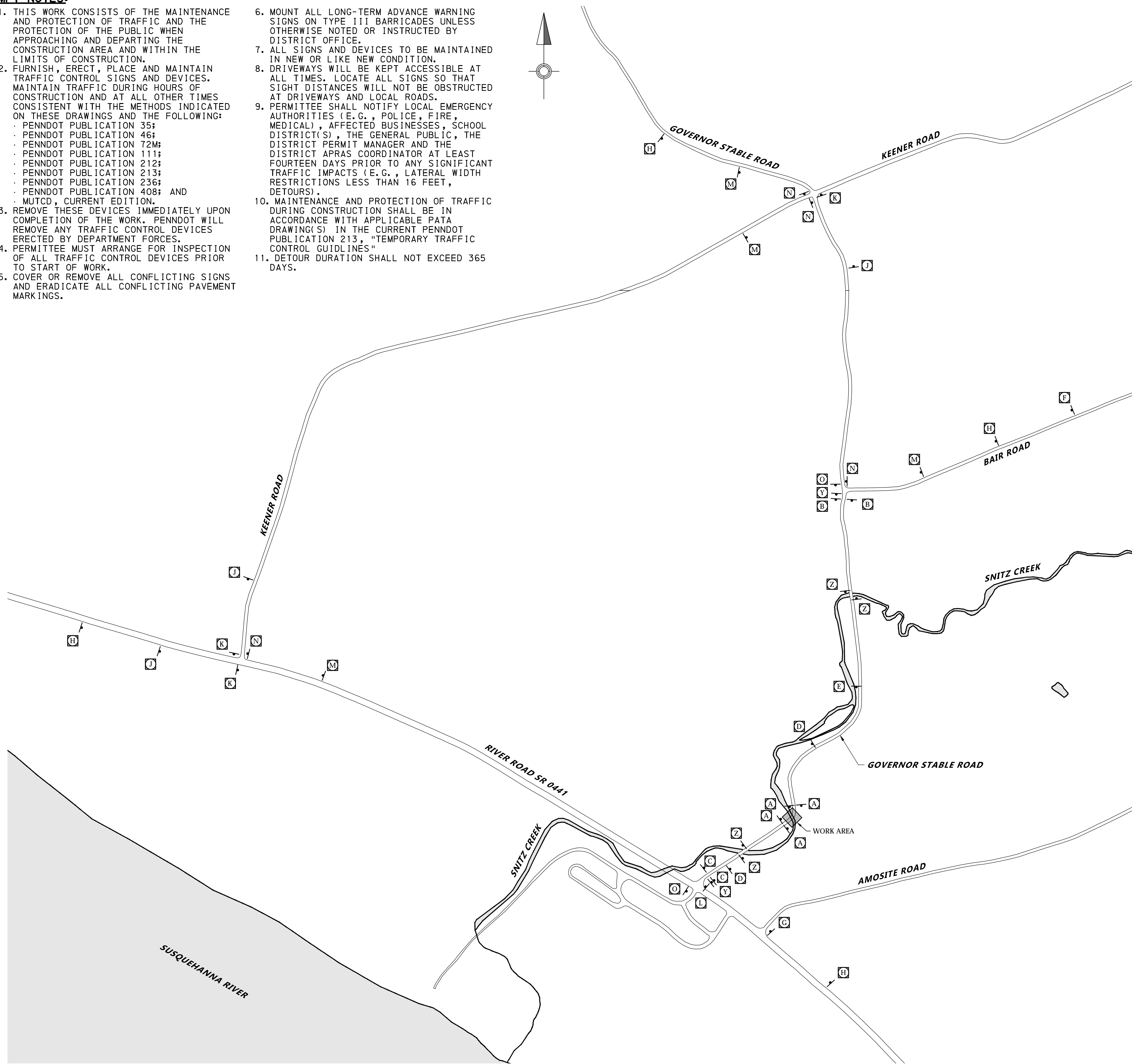
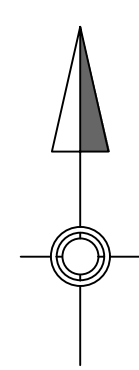

<b>A</b> ROAD CLOSED TYPE III BARRICADE R11-2 48"x30" TYPE B FLASHERS QUANTITY: 4	<b>B</b> ROAD CLOSED 0.50 MILES AHEAD LOCAL TRAFFIC ONLY TYPE III BARRICADE R11-3 48"x30" TYPE B FLASHERS QUANTITY: 2	<b>C</b> ROAD CLOSED 0.15 MILES AHEAD LOCAL TRAFFIC ONLY DETOUR TYPE III BARRICADE R11-3 48"x30" M4-10L 36"x12" TYPE B FLASHERS QUANTITY: 2
<b>D</b> ROAD CLOSED [500 FT] W20-3 36"x36" W30-1-1 20"x6" QUANTITY: 2	<b>E</b> ROAD CLOSED [1000 FT] W20-3 36"x36" W30-1-2 20"x6" QUANTITY: 1	<b>F</b> ROAD CLOSED [1500 FT] W20-3 36"x36" W30-1-3 20"x6" QUANTITY: 1
<b>G</b> DETOUR [500 FT] GOVERNOR STABLE RD W20-2 36"x36" W30-1-1 20"x6" W16-8 VARIES"x8" QUANTITY: 1	<b>H</b> DETOUR [1000 FT] GOVERNOR STABLE RD W20-2 36"x36" W30-1-2 20"x6" W16-8 VARIES"x8" QUANTITY: 4	
<b>J</b> DETOUR M4-9SL 30"x24" QUANTITY: 3	<b>K</b> DETOUR M4-9L 30"x24" QUANTITY: 3	<b>L</b> DETOUR M4-9S 30"x24" QUANTITY: 1
<b>M</b> DETOUR M4-9SR 30"x24" QUANTITY: 4	<b>N</b> DETOUR M4-9R 30"x24" QUANTITY: 4	<b>O</b> END DETOUR M4-8A 30"x24" QUANTITY: 2
<b>Y</b> WEIGHT LIMIT 5 TONS R12-1 24"x30" QUANTITY: 2 NOTE: "Y" SIGN IS NOT A PART OF THE DETOUR AND SHALL REMAIN IN PLACE PERMANENTLY	<b>Z</b> BRIDGE WEIGHT LIMIT 5 TONS R12-1-2 24"x12" R12-1 24"x30" QUANTITY: 4 NOTE: "Z" SIGN IS NOT A PART OF THE DETOUR AND SHALL REMAIN IN PLACE PERMANENTLY	

**LANCASTER COUNTY MAINTENANCE**  
(717) 299-7621

**NORTHWEST REGIONAL POLICE**  
155 MERTS DRIVE  
ELIZABETHTOWN, PA 17022  
(717) 367-8481 or 1-800-957-2677

**NORTHWEST EMS**  
ELIZABETHTOWN STATION  
380 WEST BAINBRIDGE STREET  
ELIZABETHTOWN, PA 17022  
(717) 361-8220

**BAINBRIDGE FIRE COMPANY**  
STATION 71  
34 S 2ND STREET  
BAINBRIDGE, PA 17502  
(717) 426-2177

**TRAFFIC MANAGEMENT CENTER (TMC)**  
(717) 265-7600

COUNTY LANCASTER

MUNICIPALITY CONOY TOWNSHIP

INTERSECTION \_\_\_\_\_

**GOVERNOR STABLE ROAD**

REVIEWED: \_\_\_\_\_

ASSISTANT DISTRICT EXECUTIVE \_\_\_\_\_ DATE \_\_\_\_\_

RECOMMENDED: \_\_\_\_\_

DISTRICT TRAFFIC ENGINEER \_\_\_\_\_ DATE \_\_\_\_\_

<p>DATE: _____</p> <p>SCALE: 1"=300'</p> <p>PROJECT NO. <b>CON20-23</b></p> <p>SHEET NO. <b>1</b> OF <b>1</b></p>	<p>REVISIONS:</p> <p>NO. _____</p>	<p>PLAN TITLE: <b>DETOUR PLAN</b></p> <p>PROJECT TITLE: <b>GOVERNOR STABLE ROAD BRIDGE</b></p> <p>CONOY TOWNSHIP LANCASTER COUNTY PENNSYLVANIA</p> <p>Scale: 0 100 300 600 1200</p>	<p>DESIGNED BY: _____</p> <p>CHECKED BY: R.J.L.</p> <p>DATE: 03/17/2021</p>
---	------------------------------------	---	---

**HanoverEngineering**  
Lancaster-Lebanon Office  
20 C Snyder Lane  
Ephrata, PA 17522-9101  
P: 717.721.7444  
F: 717.721.7447  
HanoverEng.com

S:\Projects\2020\CON20-23\CON20-23 - Detour.dwg, 11/14/2021, 11:14 AM